

* required information

Section 1 of 21

You can save the form at any time and resume it later. You do not need to be logged in when you resume.

System reference

Not Currently In Use

This is the unique reference for this application generated by the system.

Your reference

The Doghouse

You can put what you want here to help you track applications if you make lots of them. It is passed to the authority.

Are you an agent acting on behalf of the applicant?

☐ Yes

☒ No

Put "no" if you are applying on your own behalf or on behalf of a business you own or work for.

Applicant Details

* First name

Derek

* Family name

Hicks

* E-mail

[REDACTED]

Main telephone number

[REDACTED]

Include country code.

Other telephone number

☐ Indicate here if you would prefer not to be contacted by telephone

Are you:

☒ Applying as a business or organisation, including as a sole trader

☐ Applying as an individual

A sole trader is a business owned by one person without any special legal structure. Applying as an individual means you are applying so you can be employed, or for some other personal reason, such as following a hobby.

Applicant Business

Is your business registered in the UK with Companies House?

☒ Yes

☐ No

Note: completing the Applicant Business section is optional in this form.

Registration number

13752258

Business name

The Whickham Doghouse Ltd

If your business is registered, use its registered name.

VAT number

-

none

Put "none" if you are not registered for VAT.

Legal status

Private Limited Company

Continued from previous page...

Your position in the business

Home country

The country where the headquarters of your business is located.

Registered Address

Address registered with Companies House.

Building number or name

Street

District

City or town

County or administrative area

Postcode

Country

Section 2 of 21

PREMISES DETAILS

I/we, as named in section 1, apply for a premises licence under section 17 of the Licensing Act 2003 for the premises described in section 2 below (the premises) and I/we are making this application to you as the relevant licensing authority in accordance with section 12 of the Licensing Act 2003.

Premises Address

Are you able to provide a postal address, OS map reference or description of the premises?

☒ Address ☐ OS map reference ☐ Description

Postal Address Of Premises

Building number or name

Street

District

City or town

County or administrative area

Postcode

Country

Further Details

Telephone number

Non-domestic rateable value of premises (£)

Section 3 of 21

APPLICATION DETAILS

In what capacity are you applying for the premises licence?

- ☐ An individual or individuals
- ☒ A limited company / limited liability partnership
- ☐ A partnership (other than limited liability)
- ☐ An unincorporated association
- ☐ Other (for example a statutory corporation)
- ☐ A recognised club
- ☐ A charity
- ☐ The proprietor of an educational establishment
- ☐ A health service body
- ☐ A person who is registered under part 2 of the Care Standards Act 2000 (c14) in respect of an independent hospital in Wales
- ☐ A person who is registered under Chapter 2 of Part 1 of the Health and Social Care Act 2008 in respect of the carrying on of a regulated activity (within the meaning of that Part) in an independent hospital in England
- ☐ The chief officer of police of a police force in England and Wales

Confirm The Following

- ☒ I am carrying on or proposing to carry on a business which involves the use of the premises for licensable activities
- ☐ I am making the application pursuant to a statutory function
- ☐ I am making the application pursuant to a function discharged by virtue of Her Majesty's prerogative

Section 4 of 21

NON INDIVIDUAL APPLICANTS

Provide name and registered address of applicant in full. Where appropriate give any registered number. In the case of a partnership or other joint venture (other than a body corporate), give the name and address of each party concerned.

Non Individual Applicant's Name

Name

The Whickham Doghouse Ltd

Details

Registered number (where applicable)

13752258

Description of applicant (for example partnership, company, unincorporated association etc)

Continued from previous page...

Limited company

Address

Building number or name

Street

District

City or town

County or administrative area

Postcode

Country

Contact Details

E-mail

Telephone number

Other telephone number

* Date of birth / /
dd mm yyyy

* Nationality Documents that demonstrate entitlement to work in the UK

Add another applicant

Section 5 of 21

OPERATING SCHEDULE

When do you want the premises licence to start? / /
dd mm yyyy

If you wish the licence to be valid only for a limited period, when do you want it to end / /
dd mm yyyy

Provide a general description of the premises

For example the type of premises, its general situation and layout and any other information which could be relevant to the licensing objectives. Where your application includes off-supplies of alcohol and you intend to provide a place for consumption of these off-supplies you must include a description of where the place will be and its proximity to the premises.

I am proposing to open a micro-pub which will sell real ale and cider directly from the cask and keg made by independent producers. In addition, I propose to offer a selection of bottled beers/cider, wines and spirits. I will also stock and promote soft drinks, low and no-alcohol versions of these great tasting products. Drinking water will be available at all times. A micro-pub is not a standard pub but rather is more like a traditional alehouse providing a relaxed and sociable atmosphere for a comparatively small number of customers, without fruit machines or television it will feel like a small

Continued from previous page...

country pub despite its town centre location. It will be attractive to discerning drinkers out for a quiet pint or two. I do not intend to sell any alco-pops or liquid nitrogen containing drinks, I will not have "happy-hours" and large, same-sex groups would be discouraged from the premises. Responsible drinking will be promoted and policed by the DPS and trained out to all staff.

The premises consists of a ground floor area approximately 94 sqm and an upstairs area approximately 61 sqm. There is a walled area to the rear of the premises approximately 32sqm.

The venue is situated between a licensed restaurant and a building society with very few residential houses in the immediate vicinity. The micropub will be ran in a similar way to the existing micropub currently operating in the town.

I would like the license to include off-sales so that I can offer my customers the chance to purchase drinks to be consumed in the comfort of their own homes.

If 5,000 or more people are expected to attend the premises at any one time, state the number expected to attend

Section 6 of 21

PROVISION OF PLAYS

See guidance on regulated entertainment

Will you be providing plays?

☐ Yes

☒ No

Section 7 of 21

PROVISION OF FILMS

See guidance on regulated entertainment

Will you be providing films?

☐ Yes

☒ No

Section 8 of 21

PROVISION OF INDOOR SPORTING EVENTS

See guidance on regulated entertainment

Will you be providing indoor sporting events?

☐ Yes

☒ No

Section 9 of 21

PROVISION OF BOXING OR WRESTLING ENTERTAINMENTS

See guidance on regulated entertainment

Will you be providing boxing or wrestling entertainments?

☐ Yes

☒ No

Section 10 of 21

PROVISION OF LIVE MUSIC

See guidance on regulated entertainment

Will you be providing live music?

☐ Yes

☒ No

Section 11 of 21

Continued from previous page...

PROVISION OF RECORDED MUSIC

See guidance on regulated entertainment

Will you be providing recorded music?

☒ Yes

☐ No

Standard Days And Timings

MONDAY

Start

End

Start

End

Give timings in 24 hour clock.
(e.g., 16:00) and only give details for the days
of the week when you intend the premises
to be used for the activity.

TUESDAY

Start

End

Start

End

WEDNESDAY

Start

End

Start

End

THURSDAY

Start

End

Start

End

FRIDAY

Start

End

Start

End

SATURDAY

Start

End

Start

End

SUNDAY

Start

End

Start

End

Will the playing of recorded music take place indoors or outdoors or both?

☒ Indoors

☐ Outdoors

☐ Both

Where taking place in a building or other
structure tick as appropriate. Indoors may
include a tent.

State type of activity to be authorised, if not already stated, and give relevant further details, for example (but not exclusively) whether or not music will be amplified or unamplified.

The music will be amplified but is only intended to be background music

Continued from previous page...

State any seasonal variations for playing recorded music

For example (but not exclusively) where the activity will occur on additional days during the summer months.

None

Non-standard timings. Where the premises will be used for the playing of recorded music at different times from those listed in the column on the left, list below

For example (but not exclusively), where you wish the activity to go on longer on a particular day e.g. Christmas Eve.

Christmas eve, new years eve and special occasions

Section 12 of 21

PROVISION OF PERFORMANCES OF DANCE

See guidance on regulated entertainment

Will you be providing performances of dance?

☐ Yes

☒ No

Section 13 of 21

PROVISION OF ANYTHING OF A SIMILAR DESCRIPTION TO LIVE MUSIC, RECORDED MUSIC OR PERFORMANCES OF DANCE

See guidance on regulated entertainment

Will you be providing anything similar to live music, recorded music or performances of dance?

☒ Yes

☐ No

Standard Days And Timings

MONDAY

Start

End

Start

End

TUESDAY

Start

End

Start

End

WEDNESDAY

Start

End

Start

End

Give timings in 24 hour clock.
(e.g., 16:00) and only give details for the days
of the week when you intend the premises
to be used for the activity.

Continued from previous page...

THURSDAY

Start

End

Start

End

FRIDAY

Start

End

Start

End

SATURDAY

Start

End

Start

End

SUNDAY

Start

End

Start

End

Give a description of the type of entertainment that will be provided

I would like the opportunity to expand the quality of evening entertainment on offer in the locality by trying comedy nights, etc.

Will this entertainment take place indoors or outdoors or both?

☒ Indoors ☐ Outdoors ☐ Both

Where taking place in a building or other structure tick as appropriate. Indoors may include a tent.

State type of activity to be authorised, if not already stated, and give relevant further details, for example (but not exclusively) whether or not music will be amplified or unamplified.

music may be amplified or compares/acts microphone

State any seasonal variations for entertainment

For example (but not exclusively) where the activity will occur on additional days during the summer months.

none

Non-standard timings. Where the premises will be used for entertainment at different times from those listed in the column on the left, list below

For example (but not exclusively), where you wish the activity to go on longer on a particular day e.g. Christmas Eve.

none

Continued from previous page...

Section 14 of 21

LATE NIGHT REFRESHMENT

Will you be providing late night refreshment?

☐ Yes

☒ No

Section 15 of 21

SUPPLY OF ALCOHOL

Will you be selling or supplying alcohol?

☒ Yes

☐ No

Standard Days And Timings

MONDAY

Start

End

Start

End

TUESDAY

Start

End

Start

End

WEDNESDAY

Start

End

Start

End

THURSDAY

Start

End

Start

End

FRIDAY

Start

End

Start

End

SATURDAY

Start

End

Start

End

SUNDAY

Start

End

Start

End

Give timings in 24 hour clock.
(e.g., 16:00) and only give details for the days
of the week when you intend the premises
to be used for the activity.

Continued from previous page...

Will the sale of alcohol be for consumption:

☐ On the premises ☐ Off the premises ☒ Both

If the sale of alcohol is for consumption on the premises select on, if the sale of alcohol is for consumption away from the premises select off. If the sale of alcohol is for consumption on the premises and away from the premises select both.

State any seasonal variations

For example (but not exclusively) where the activity will occur on additional days during the summer months.

I intend to adjust my opening times based on customer habit and will reduce opening hours based on these findings. The hours will not fall outside of the times stated above

Non-standard timings. Where the premises will be used for the supply of alcohol at different times from those listed in the column on the left, list below

For example (but not exclusively), where you wish the activity to go on longer on a particular day e.g. Christmas Eve.

State the name and details of the individual whom you wish to specify on the licence as premises supervisor

Name

First name

Family name

Date of birth / /

Enter the contact's address

Building number or name

Street

District

City or town

County or administrative area

Postcode

Country

Personal Licence number (if known)

Continued from previous page...

Issuing licensing authority
(if known)

PROPOSED DESIGNATED PREMISES SUPERVISOR CONSENT

How will the consent form of the proposed designated premises supervisor be supplied to the authority?

- ☐ Electronically, by the proposed designated premises supervisor
- ☒ As an attachment to this application

Reference number for consent form (if known)

If the consent form is already submitted, ask the proposed designated premises supervisor for its 'system reference' or 'your reference'.

Section 16 of 21

ADULT ENTERTAINMENT

Highlight any adult entertainment or services, activities, or other entertainment or matters ancillary to the use of the premises that may give rise to concern in respect of children

Give information about anything intended to occur at the premises or ancillary to the use of the premises which may give rise to concern in respect of children, regardless of whether you intend children to have access to the premises, for example (but not exclusively) nudity or semi-nudity, films for restricted age groups etc gambling machines etc.

There will be no adult entertainment, no TV showing restricted age shows and no gambling machines on site

Section 17 of 21

HOURS PREMISES ARE OPEN TO THE PUBLIC

Standard Days And Timings

MONDAY

Start

End

Start

End

Give timings in 24 hour clock.
(e.g., 16:00) and only give details for the days of the week when you intend the premises to be used for the activity.

TUESDAY

Start

End

Start

End

WEDNESDAY

Start

End

Start

End

THURSDAY

Start

End

Start

End

Continued from previous page...

FRIDAY

Start

End

Start

End

SATURDAY

Start

End

Start

End

SUNDAY

Start

End

Start

End

State any seasonal variations

For example (but not exclusively) where the activity will occur on additional days during the summer months.

none

Non standard timings. Where you intend to use the premises to be open to the members and guests at different times from those listed in the column on the left, list below

For example (but not exclusively), where you wish the activity to go on longer on a particular day e.g. Christmas Eve.

Section 18 of 21

LICENSING OBJECTIVES

Describe the steps you intend to take to promote the four licensing objectives:

a) General – all four licensing objectives (b,c,d,e)

List here steps you will take to promote all four licensing objectives together.

I (the owner of the business) will be the Designated Premises Supervisor and I am a holder of a Personal licence to sell alcohol. I expect to be present on the premises when the premises are open but in the few occasions when this is not possible, I will have experienced staff available who will have been trained in all policies relating to the operating schedule and the four licensing objectives.

I will be contactable at all times during licensable activities being conducted on the premises.

I may not have a vast experience in running a licensed premise however I have ran corporate social events and I am used to dealing with large numbers of employees (100+) in a manufacturing environment so have considerable experience spotting drink/drug use and dealing rationally with irrational people. I also intend to hire experienced staff as support and will ensure that these are legally allowed to work in the UK.

b) The prevention of crime and disorder

The premises will have a zero tolerance to drugs policy. Anyone suspected of being under the influence will be refused entry/service and anyone suspected of taking drugs on site will be removed from the premises.

Continued from previous page...

Customers who appear to be intoxicated will not be served and told to leave or refused entry if trying to gain access.

I will display 'Challenge 25' notices to remind customers they may be asked to show proof of age (passport, driving licence or PASS- accredited card only). Notices also will be displayed stating that drug use and violent/anti-social behaviour will not be tolerated on the premises.

Information will be displayed on the premises explaining what a unit of alcohol is and how it translates in practical terms to the drinks sold, together with information about the risks of drunk driving and chronic drinking. All beer or cider will be available in half pints; stronger beers and ciders will be sold only in smaller measures.

Wherever possible toughened glassware will be used.

A colour digital CCTV system will be operational at the premises at all times when licensable activities are being carried out and at any other times where members of the public are present on the premises.

- The CCTV system shall contain the correct time and date stamp information.
- The CCTV system will cover all areas of the premises occupied by the public under the terms of the licence. It will also show the areas immediately outside of the premises.
- The CCTV system will be capable of providing quality images of good evidential value. The CCTV system will have sufficient storage retention capacity for a minimum of 28 days continuous footage.
- The CCTV footage will be controlled and kept in a secure environment to prevent tampering or unauthorised viewing.
- The data controller, under the data protection act 1998, who is responsible for any CCTV images captured on cameras on the premises will, on the lawful request of an authorised officer or an officer of Northumbria Police, cause any required footage to be downloaded immediately, or where this is not possible, as soon as reasonably practicable, and supplied to the requesting officer. Where the CCTV images are not supplied at the time of the request being made the data controller will ensure that they are secured to prevent any overwriting.
- The CCTV system will be adequately maintained and be capable of transporting recorded material onto a removable media. The CCTV system replay software must allow an authorised officer or an officer of Northumbria Police to search the picture footage effectively and see all the information contained in the picture footage for the purposes of detecting, investigating and preventing crime. It must be possible to replay exported files immediately e.g. no indexing of files or verification checks.
- No device shall be permitted that could in any way adversely affect or impede the quality of the images recorded by the CCTV system, e.g. smoke or dry ice machines.

I will conform to the Portman Group code of practice on the naming, packaging and promotion of alcoholic drinks at all times.

An incident book will be kept to log any refusals on the basis of no proof of age, intoxication or anti-social behaviour. All of the above will be communicated to staff members during training, the notes for which will be left behind the bar for reference.

I will join local initiatives to reduce crime and unreasonable behaviour resulting from alcohol usage (pubwatch, etc) and will participate in any local ring round phone system or radio link.

I will employ specific measures to discourage binge drinking by providing chairs for most of my customers, there will not be a 'happy hour' and a community spirit will be promoted within the premises.

Through this I expect my micro-pub to appeal to discerning, mature customers who are sensible about drinking. I would be happy to take further guidance from the local police in this matter and to take part in any campaigns promoting safe, sensible, and social drinking.

c) Public safety

I am aware of the need to conduct ongoing Health & Safety risk assessments to identify and deal with hazards that might involve tripping, manual handling, electric shock, hazardous substances, etc. I also will conduct ongoing fire risk assessments. I am IOSH accredited so understand how to carry out and the importance of completing regular risk assessments.

Staff will be advised of the findings from the risk assessments during training, the notes for which will be left behind the bar for reference. Staff will also be asked to undertake First Aid and fire safety training, so they are aware of potential hazards and what to do in emergencies.

Access will always be granted to the emergency services to the premises and access doorways will be kept clear and unobstructed.

The licensable activities regard the sale of alcohol and the provision of recorded music, although the recorded music will be kept to a background level as to encourage conversation between customers.

Continued from previous page...

No other licensable activities will be carried out in the premises including any adult entertainment.

There will be no pyrotechnics used in the premises, including smoke machines or anything that will obscure the CCTV footage.

Lighting around the building will be monitored and maintained to ensure safe entry/exit to the premises.

Because of the type of products I sell and the ambience I will try to create in the premises, the target customer of the premises to be 35+ years of age. This target customer drinks in moderation and does not drink in large groups. I want couples to feel welcomed into the premises so will be selling wines and spirits to encourage this behaviour. Large, same sex groups will be discouraged at all times.

Smaller measures of all alcohol sold will be advertised and available: ales/cider will be available in half pints, spirits in 25ml and wine in 125ml.

The opening times requested are between 11:00 and 23:00 all days, however I fully intend to adjust these opening times, to the needs of my customers. Any adjustments will reduce the number of hours operational and never exceed these times.

Last orders are to be call 30 minutes before the closing time to enable a sensible time to finish drinks and encourage a structured leaving time for customers. This will discourage an "en masse" end to the night and lots of people leaving at the same time.

In terms of layout, the public areas will be comprised mainly of seating with tables and chairs with fixed seating around the perimeter. The only standing area will be in the bar area where seating will also be provided. The capacity of the premises will be approximately 45 (confirmed when I get final layout drawings)

Entry to the building will be through the existing front and rear doors which will be signed as a fire exits.

The bar will be placed in such a way that the entire premises can be monitored.

The premises will be monitored by CCTV and smoke alarms will be installed. A logbook will be maintained to show that regular checks have been carried out to ensure smoke alarms, gas and electrical appliances, plus gas supply and electrical wiring are all working properly.

d) The prevention of public nuisance

I am requesting hours to sell alcohol which are within the normal trading hours of other local pubs (11:00 until 23:00). After judging trade patterns, I will probably choose to reduce my opening hours accordingly.

The beer garden area to the rear will be closed daily at 21:30 to prevent noise disturbance, notices will be displayed to this effect.

There will be no smoking policy within the premises and signage to indicate this. Smoking will only be permitted in the beer garden area and this will be cleaned daily to prevent litter.

There are currently air conditioning units on site and these will be utilised in the new premises, any further units will be properly vented and assessed to ensure there is no additional noise pollution.

Deliveries and waste collection will be carried out during normal working hours (between 11:00 and 17:00) this includes waste glass disposal.

Local taxi phone numbers will be available and displayed on leaving the premises

Prominent, clear and legible notices shall be displayed at all exits requesting the public to respect the needs of local residents and to leave the premises and the area quietly.

Noise will be kept to a minimum: Recorded music will be kept to background levels at all times.

Staff will be made aware of the above policies during training, the notes for which will be left behind the bar for reference.

Notices will be posted at the door asking patrons to leave quietly.

The premises is not within 50m of any hospitals, hospices, schools or places of worship. There are very few residential properties in the immediate vicinity of the property. I would be happy to take further guidance from the Environmental Health Department in this matter.

e) The protection of children from harm

I will not sell alcohol to any person under the age of 18. Anyone under the age of 18 will be accompanied and supervised by an adult and will be served only soft drinks. They will be asked to vacate the premises by 21:00.

I will display 'Challenge 25' notices to remind customers they may be asked to show proof of age (passport, driving licence or PASS- accredited card only).

There will be no gambling machines on the premises

There will be no adult entertainment or TV/films on the premises.

There will be a zero tolerance to drug taking/dealing on the premises.

Continued from previous page...

Notices also will be displayed stating that drug use and violent/anti-social behaviour will not be tolerated on the premises. Records will be kept of all staff members participating in the sale of alcohol on the premises and will be always available to the relevant authorities.

I will put into operation measures recommended by the Portman Group in respect to the promotion and marketing of alcohol. There will be no alco-pops or "happy hour" promotions. All ABV's will be displayed for the cask/keg products served and all bottled products will be marked with the ABV.

I will check the Home office website regularly to ensure the price per alcohol unit limit has not been breached.

All wholesalers will be AWRS approved to ensure supply and there will be no mobile, remote, internet or delivery sales provided.

No service will be provided to anyone intoxicated.

No late night refreshments will be sold.

Anyone suspected of "shoulder Tapping" or trying to purchase alcohol for persons under the age of 18 will be refused and recorded.

No open vessel alcohol will be permitted to leave the premises. All off-site sales will be judged in the same way to on sales, if I think it will lead to anti-social behaviour or drunkenness, this will be refused.

The beer garden area is enclosed and not a shared space, any litter generated will be the responsibility of the owner to tidy and dispose of, however bins and ash trays will be provided. I intend to close the outside space by 21:30 daily to prevent noise pollution.

CCTV will monitor the outside areas as described above.

I am open to any further suggestions for improvement that any of the licencing authorities feel is necessary.

A documented staff training programme shall be provided to all members of staff at the premises in respect of the:-

- operation of the CCTV system (including the downloading of evidence);
- retail sale of alcohol;
- age verification policy;
- conditions attached to the Premises Licence;
- permitted licensable activities;
- the licensing objectives; and
- opening times for the venue.

A Refusal Register and an Incident Report Register shall be maintained at the premises. Such registers will record incidents of staff refusals to under age or drunk people as well as incidents of any anti-social behaviour and ejections from the premises. Such Registers shall be kept for a minimum of one year. [For the avoidance of doubt, the one year period relates to each respective entry in a Register and runs from the date of that particular entry in the Register.

Section 19 of 21

NOTES ON DEMONSTRATING ENTITLEMENT TO WORK IN THE UK

Continued from previous page...

Entitlement to work/immigration status for individual applicants and applications from partnerships which are not limited liability partnerships:

A licence may not be held by an individual or an individual in a partnership who is resident in the UK who:

- does not have the right to live and work in the UK; or
- is subject to a condition preventing him or her from doing work relating to the carrying on of a licensable activity.

Any premises licence issued in respect of an application made on or after 6 April 2017 will become invalid if the holder ceases to be entitled to work in the UK.

Applicants must demonstrate that they have an entitlement to work in the UK and are not subject to a condition preventing them from doing work relating to the carrying on of a licensable activity. They do this in one of two ways: 1) by providing with this application copies or scanned copies of the documents listed below (which do not need to be certified), or 2) by providing their 'share code' to enable the licensing authority to carry out a check using the Home Office online right to work checking service (see below).

Documents which demonstrate entitlement to work in the UK

- An expired or current passport showing the holder, or a person named in the passport as the child of the holder, is a British citizen or a citizen of the UK and Colonies having the right of abode in the UK [please see note below about which sections of the passport to copy].
- An expired or current passport or national identity card showing the holder, or a person named in the passport as the child of the holder, is a national of a European Economic Area country or Switzerland.
- A Registration Certificate or document certifying permanent residence issued by the Home Office to a national of a European Economic Area country or Switzerland.
- A Permanent Residence Card issued by the Home Office to the family member of a national of a European Economic Area country or Switzerland.
- A **current** Biometric Immigration Document (Biometric Residence Permit) issued by the Home Office to the holder indicating that the person named is allowed to stay indefinitely in the UK, or has no time limit on their stay in the UK.
- A **current** passport endorsed to show that the holder is exempt from immigration control, is allowed to stay indefinitely in the UK, has the right of abode in the UK, or has no time limit on their stay in the UK.
- A **current** Immigration Status Document issued by the Home Office to the holder with an endorsement indicating that the named person is allowed to stay indefinitely in the UK or has no time limit on their stay in the UK, **when produced in combination with** an official document giving the person's permanent National Insurance number and their name issued by a Government agency or a previous employer.
- A birth or adoption certificate issued in the UK, **when produced in combination with** an official document giving the person's permanent National Insurance number and their name issued by a Government agency or a previous employer.
- A birth or adoption certificate issued in the Channel Islands, the Isle of Man or Ireland **when produced in combination with** an official document giving the person's permanent National Insurance number and their name issued by a Government agency or a previous employer.
- A certificate of registration or naturalisation as a British citizen, **when produced in combination with** an official document giving the person's permanent National Insurance number and their name issued by a Government agency or a previous employer.

Continued from previous page...

- A **current** passport endorsed to show that the holder is allowed to stay in the UK and is currently allowed to work and is not subject to a condition preventing the holder from doing work relating to the carrying on of a licensable activity.
- A **current** Biometric Immigration Document (Biometric Residence Permit) issued by the Home Office to the holder which indicates that the named person can currently stay in the UK and is allowed to work relation to the carrying on of a licensable activity.
- A **current** Residence Card issued by the Home Office to a person who is not a national of a European Economic Area state or Switzerland but who is a family member of such a national or who has derivative rights or residence.
- A **current** Immigration Status Document containing a photograph issued by the Home Office to the holder with an endorsement indicating that the named person may stay in the UK, and is allowed to work and is not subject to a condition preventing the holder from doing work relating to the carrying on of a licensable activity **when produced in combination with** an official document giving the person's permanent National Insurance number and their name issued by a Government agency or a previous employer.
- A Certificate of Application, **less than 6 months old**, issued by the Home Office under regulation 18(3) or 20(2) of the Immigration (European Economic Area) Regulations 2016, to a person who is not a national of a European Economic Area state or Switzerland but who is a family member of such a national or who has derivative rights of residence.
- Reasonable evidence that the person has an outstanding application to vary their permission to be in the UK with the Home Office such as the Home Office acknowledgement letter or proof of postage evidence, or reasonable evidence that the person has an appeal or administrative review pending on an immigration decision, such as an appeal or administrative review reference number.
- Reasonable evidence that a person who is not a national of a European Economic Area state or Switzerland but who is a family member of such a national or who has derivative rights of residence in exercising treaty rights in the UK including:-
 - evidence of the applicant's own identity – such as a passport,
 - evidence of their relationship with the European Economic Area family member – e.g. a marriage certificate, civil partnership certificate or birth certificate, and
 - evidence that the European Economic Area national has a right of permanent residence in the UK or is one of the following if they have been in the UK for more than 3 months:
 - (i) working e.g. employment contract, wage slips, letter from the employer,
 - (ii) self-employed e.g. contracts, invoices, or audited accounts with a bank,
 - (iii) studying e.g. letter from the school, college or university and evidence of sufficient funds; or
 - (iv) self-sufficient e.g. bank statements.

Family members of European Economic Area nationals who are studying or financially independent must also provide evidence that the European Economic Area national and any family members hold comprehensive sickness insurance in the UK. This can include a private medical insurance policy, an EHIC card or an S1, S2 or S3 form.

Original documents must not be sent to licensing authorities. If the document copied is a passport, a copy of the following pages should be provided:-

- (i) any page containing the holder's personal details including nationality;
- (ii) any page containing the holder's photograph;
- (iii) any page containing the holder's signature;
- (iv) any page containing the date of expiry; and
- (v) any page containing information indicating the holder has permission to enter or remain in the UK and is permitted to work.

Continued from previous page...

If the document is not a passport, a copy of the whole document should be provided.

Your right to work will be checked as part of your licensing application and this could involve us checking your immigration status with the Home Office. We may otherwise share information with the Home Office. Your licence application will not be determined until you have complied with this guidance.

Home Office online right to work checking service

As an alternative to providing a copy of the documents listed above, applicants may demonstrate their right to work by allowing the licensing authority to carry out a check with the Home Office online right to work checking service.

To demonstrate their right to work via the Home Office online right to work checking service, applicants should include in this application their 9-digit share code (provided to them upon accessing the service at <https://www.gov.uk/prove-right-to-work>) which, along with the applicant's date of birth (provided within this application), will allow the licensing authority to carry out the check.

In order to establish the applicant's right to work, the check will need to indicate that the applicant is allowed to work in the United Kingdom and is not subject to a condition preventing them from doing work relating to the carrying on of a licensable activity.

An online check will not be possible in all circumstances because not all applicants will have an immigration status that can be checked online. The Home Office online right to work checking service sets out what information and/or documentation applicants will need in order to access the service. Applicants who are unable to obtain a share code from the service should submit copy documents as set out above.

Section 20 of 21

NOTES ON REGULATED ENTERTAINMENT

Continued from previous page...

In terms of specific **regulated entertainments** please note that:

- Plays: no licence is required for performances between 08.00 and 23.00 on any day, provided that the audience does not exceed 500.
- Films: no licence is required for 'not-for-profit' film exhibition held in community premises between 08.00 and 23.00 on any day provided that the audience does not exceed 500 and the organiser (a) gets consent to the screening from a person who is responsible for the premises; and (b) ensures that each such screening abides by age classification ratings.
- Indoor sporting events: no licence is required for performances between 08.00 and 23.00 on any day, provided that the audience does not exceed 1000.
- Boxing or Wrestling Entertainment: no licence is required for a contest, exhibition or display of Greco-Roman wrestling, or freestyle wrestling between 08.00 and 23.00 on any day, provided that the audience does not exceed 1000. Combined fighting sports – defined as a contest, exhibition or display which combines boxing or wrestling with one or more martial arts – are licensable as a boxing or wrestling entertainment rather than an indoor sporting event.
- Live music: no licence permission is required for:
 - o a performance of unamplified live music between 08.00 and 23.00 on any day, on any premises.
 - o a performance of amplified live music between 08.00 and 23.00 on any day on premises authorised to sell alcohol for consumption on those premises, provided that the audience does not exceed 500.
 - o a performance of amplified live music between 08.00 and 23.00 on any day, in a workplace that is not licensed to sell alcohol on those premises, provided that the audience does not exceed 500.
 - o a performance of amplified live music between 08.00 and 23.00 on any day, in a church hall, village hall, community hall, or other similar community premises, that is not licensed by a premises licence to sell alcohol, provided that (a) the audience does not exceed 500, and (b) the organiser gets consent for the performance from a person who is responsible for the premises.
 - o a performance of amplified live music between 08.00 and 23.00 on any day, at the non-residential premises of (i) a local authority, or (ii) a school, or (iii) a hospital, provided that (a) the audience does not exceed 500, and (b) the organiser gets consent for the performance on the relevant premises from: (i) the local authority concerned, or (ii) the school or (iii) the health care provider for the hospital.
- Recorded Music: no licence permission is required for:
 - o any playing of recorded music between 08.00 and 23.00 on any day on premises authorised to sell alcohol for consumption on those premises, provided that the audience does not exceed 500.
 - o any playing of recorded music between 08.00 and 23.00 on any day, in a church hall, village hall, community hall, or other similar community premises, that is not licensed by a premises licence to sell alcohol, provided that (a) the audience does not exceed 500, and (b) the organiser gets consent for the performance from a person who is responsible for the premises.
 - o any playing of recorded music between 08.00 and 23.00 on any day, at the non-residential premises of (i) a local authority, or (ii) a school, or (iii) a hospital, provided that (a) the audience does not exceed 500, and (b) the organiser gets consent for the performance on the relevant premises from: (i) the local authority concerned, or (ii) the school proprietor or (iii) the health care provider for the hospital.

Continued from previous page...

- Dance: no licence is required for performances between 08.00 and 23.00 on any day, provided that the audience does not exceed 500. However, a performance which amounts to adult entertainment remains licensable.
- Cross activity exemptions: no licence is required between 08.00 and 23.00 on any day, with no limit on audience size for:
 - o any entertainment taking place on the premises of the local authority where the entertainment is provided by or on behalf of the local authority;
 - o any entertainment taking place on the hospital premises of the health care provider where the entertainment is provided by or on behalf of the health care provider;
 - o any entertainment taking place on the premises of the school where the entertainment is provided by or on behalf of the school proprietor; and
 - o any entertainment (excluding films and a boxing or wrestling entertainment) taking place at a travelling circus, provided that (a) it takes place within a moveable structure that accommodates the audience, and (b) that the travelling circus has not been located on the same site for more than 28 consecutive days.

Section 21 of 21

PAYMENT DETAILS

This fee must be paid to the authority. If you complete the application online, you must pay it by debit or credit card.

Premises Licence Fees are determined by the non-domestic rateable value of the premises.

To find out a premises non domestic rateable value go to the Valuation Office Agency site at http://www.voa.gov.uk/business_rates/index.htm

Band A - No RV to £4300 £100.00

Band B - £4301 to £33000 £190.00

Band C - £33001 to £87000 £315.00

Band D - £87001 to £125000 £450.00*

Band E - £125001 and over £635.00*

*If the premises rateable value is in Bands D or E and the premises is primarily used for the consumption of alcohol on the premises then you are required to pay a higher fee

Band D - £87001 to £125000 £900.00

Band E - £125001 and over £1,905.00

There is an exemption from the payment of fees in relation to the provision of regulated entertainment at church halls, chapel halls or premises of a similar nature, village halls, parish or community halls, or other premises of a similar nature. The costs associated with these licences will be met by central Government. If, however, the licence also authorises the use of the premises for the supply of alcohol or the provision of late night refreshment, a fee will be required.

Schools and sixth form colleges are exempt from the fees associated with the authorisation of regulated entertainment where the entertainment is provided by and at the school or college and for the purposes of the school or college.

If you operate a large event you are subject to ADDITIONAL fees based upon the number in attendance at any one time

Capacity 5000-9999 £1,000.00

Capacity 10000 -14999 £2,000.00

Capacity 15000-19999 £4,000.00

Capacity 20000-29999 £8,000.00

Capacity 30000-39000 £16,000.00

Capacity 40000-49999 £24,000.00

Capacity 50000-59999 £32,000.00

Capacity 60000-69999 £40,000.00

Capacity 70000-79999 £48,000.00

Capacity 80000-89999 £56,000.00

Capacity 90000 and over £64,000.00

* Fee amount (£)

190.00

ATTACHMENTS

AUTHORITY POSTAL ADDRESS

Continued from previous page...

Address

Building number or name	<input type="text"/>
Street	<input type="text"/>
District	<input type="text"/>
City or town	<input type="text"/>
County or administrative area	<input type="text"/>
Postcode	<input type="text"/>
Country	<input type="text" value="United Kingdom"/>

DECLARATION

[Applicable to individual applicants only, including those in a partnership which is not a limited liability partnership] I understand I am not entitled to be issued with a licence if I do not have the entitlement to live and work in the UK (or if I am subject to a condition preventing me from doing work relating to the carrying on of a licensable activity) and that my * licence will become invalid if I cease to be entitled to live and work in the UK (please read guidance note 15). The DPS named in this application form is entitled to work in the UK (and is not subject to conditions preventing him or her from doing work relating to a licensable activity) and I have seen a copy of his or her proof of entitlement to work, if appropriate (please see note 15).

☐ Ticking this box indicates you have read and understood the above declaration

This section should be completed by the applicant, unless you answered "Yes" to the question "Are you an agent acting on behalf of the applicant?"

* Full name	<input type="text"/>
* Capacity	<input type="text"/>
Date (dd/mm/yyyy)	<input type="text"/>

Add another signatory

Once you're finished you need to do the following:

1. Save this form to your computer by clicking file/save as...
2. Go back to <https://www.gov.uk/apply-for-a-licence/premises-licence/gateshead/apply-1> to upload this file and continue with your application.

Don't forget to make sure you have all your supporting documentation to hand.

IT IS AN OFFENCE LIABLE TO SUMMARY CONVICTION TO A FINE OF ANY AMOUNT UNDER SECTION 158 OF THE LICENSING ACT 2003, TO MAKE A FALSE STATEMENT IN OR IN CONNECTION WITH THIS APPLICATION

IT IS AN OFFENCE UNDER SECTION 24B OF THE IMMIGRATION ACT 1971 FOR A PERSON TO WORK WHEN THEY KNOW, OR HAVE REASONABLE CAUSE TO BELIEVE, THAT THEY ARE DISQUALIFIED FROM DOING SO BY REASON OF THEIR IMMIGRATION STATUS. THOSE WHO EMPLOY AN ADULT WITHOUT LEAVE OR WHO IS SUBJECT TO CONDITIONS AS TO EMPLOYMENT WILL BE LIABLE TO A CIVIL PENALTY UNDER SECTION 15 OF THE IMMIGRATION, ASYLUM AND NATIONALITY ACT 2006 AND PURSUANT TO SECTION 21 OF THE SAME ACT, WILL BE COMMITTING AN OFFENCE WHERE THEY DO SO IN THE KNOWLEDGE, OR WITH REASONABLE CAUSE TO BELIEVE, THAT THE EMPLOYEE IS DISQUALIFIED

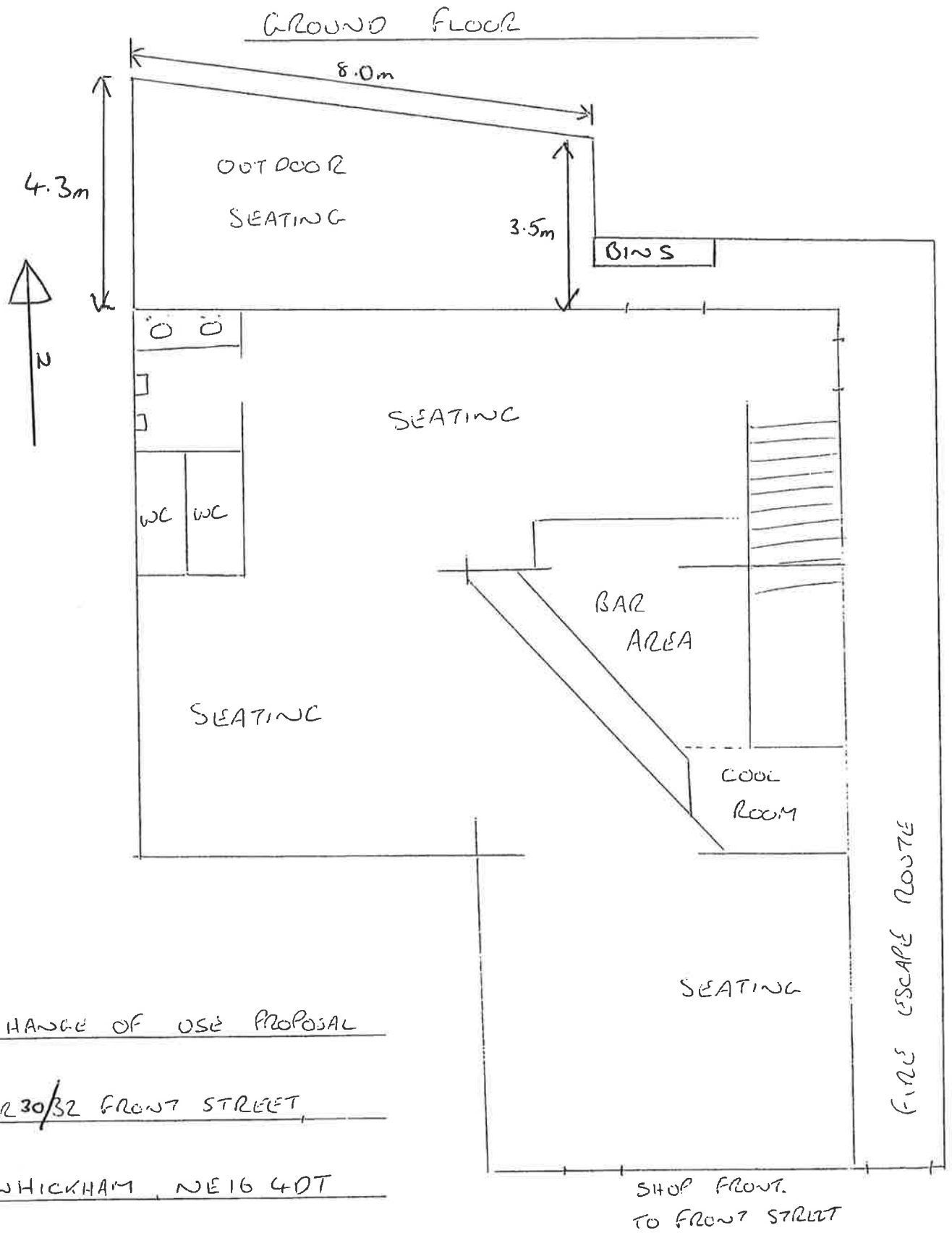

CHANGE OF USE PROPOSAL

FOR 30/32 FRONT STREET,

WHICKHAM, NE16 4DT

1ST FLOOR PROPOSAL
30/32 FRONT STREET

